

Soils Map

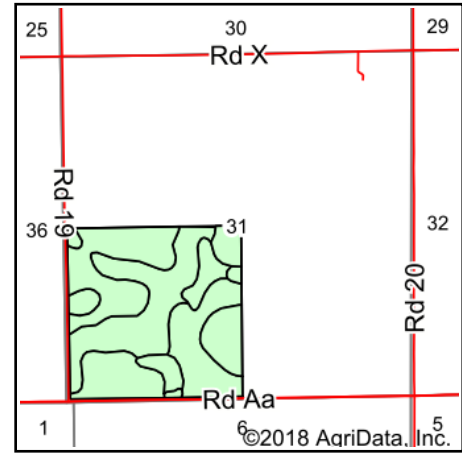
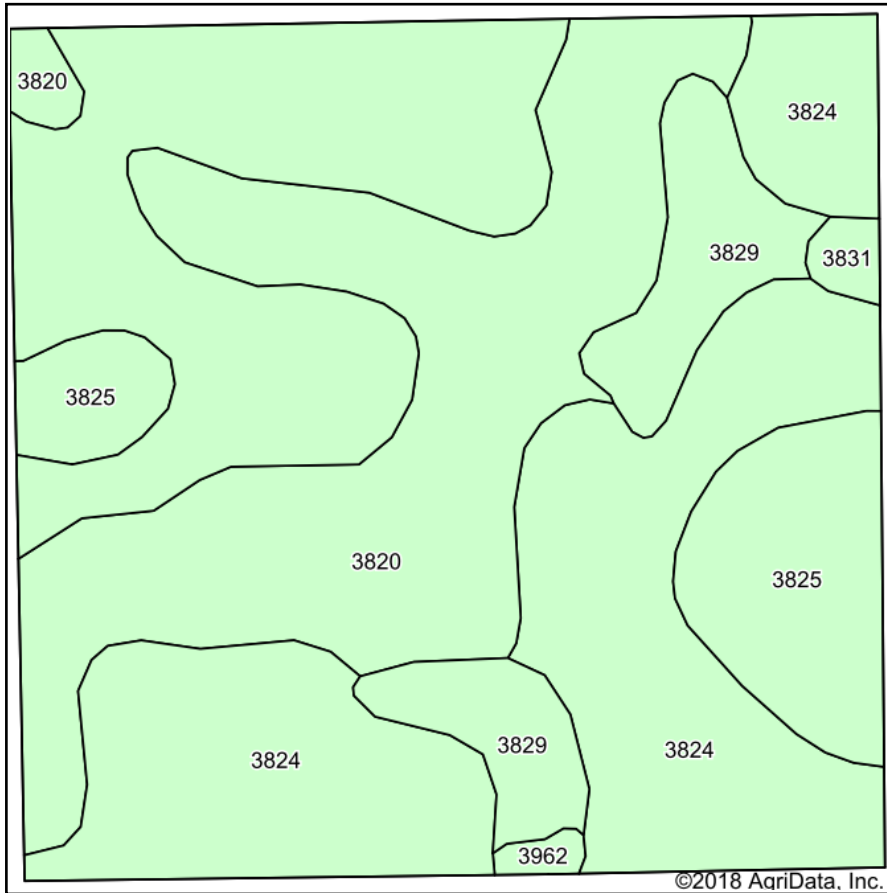

State: **Nebraska**
 County: **Fillmore**
 Location: **31-5N-1W**
 Township: **Franklin**
 Acres: **159.33**
 Date: **9/7/2018**

 **The Pinnacle Agency**
 FARM MANAGEMENT-REAL ESTATE

Maps Provided By:

 © Agridata, Inc. 2018 www.AgridataInc.com



Area Symbol: NE059, Soil Area Version: 16

Code	Soil Description	Acres	Percent of field	Non-Irr Class *c	Irr Class *c	SRPG	NCCPI Soybeans
3824	Crete silt loam, 0 to 1 percent slopes	85.22	53.5%	Ils	Ils	70	62
3820	Butler silt loam, 0 to 1 percent slopes	44.34	27.8%	IIw	IIw	74	60
3825	Crete silt loam, 1 to 3 percent slopes	15.47	9.7%	Ile	Ile	68	61
3829	Crete silty clay loam, 1 to 3 percent slopes	12.47	7.8%	Ile	Ile	71	60
3831	Crete silty clay loam, 3 to 7 percent slopes, eroded	1.13	0.7%	IIIe	IIIe	67	49
3962	Hastings silty clay loam, 7 to 11 percent slopes, eroded	0.70	0.4%	IVe	IVe	66	53
Weighted Average						71	61.1

*c: Using Capabilities Class Dominant Condition Aggregation Method

Soils data provided by USDA and NRCS.