

# Soils Map

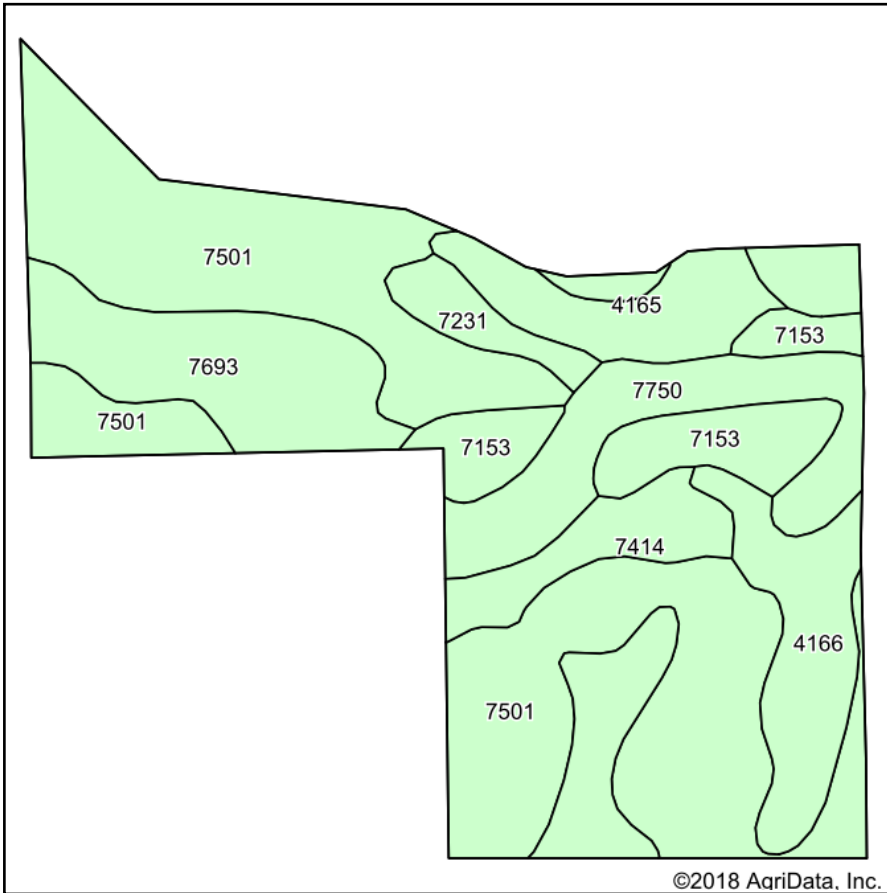

Soils data provided by USDA and NRCS.

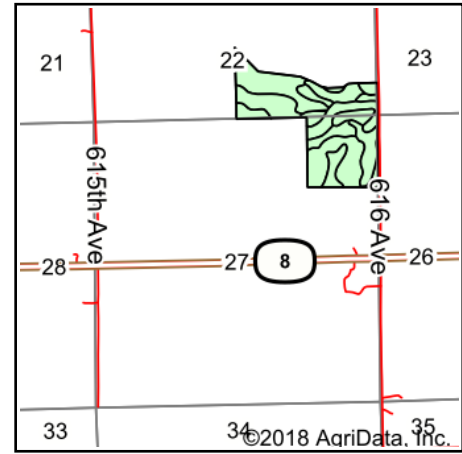

State: **Nebraska**  
 County: **Pawnee**  
 Location: **27-2N-10E**  
 Township: **Precinct 5, Burchard**  
 Acres: **85.37**  
 Date: **2/6/2018**

 **The Pinnacle Agency**  
 FARM MANAGEMENT-REAL ESTATE

Maps Provided By:  
  
 CUSTOMIZED ONLINE MAPPING  
 © AgriData, Inc. 2018 www.AgriDataInc.com



## Area Symbol: NE133, Soil Area Version: 16

Code	Soil Description	Acres	Percent of field	Non-Irr Class *c	Irr Class *c	SRPG	Alfalfa hay	Corn	Grain sorghum	Soybeans	Winter wheat
7501	Pawnee clay loam, 4 to 8 percent slopes, eroded	38.89	45.6%	Ille							
7693	Wymore silty clay loam, 2 to 6 percent slopes	13.08	15.3%	Ille	Ille	69					
7750	Nodaway silt loam, occasionally flooded	8.20	9.6%	Ilw		61	5	89	89	40	35
4166	Kipson-Sogn complex, 3 to 30 percent slopes	6.88	8.1%	Vls		1					
7153	Kennebec silt loam, rarely flooded	6.85	8.0%	Iw		86					
4165	Kipson-Benfield silty clay loams, 7 to 17 percent slopes	5.23	6.1%	Vle		22					
7414	Mayberry loam, 3 to 11 percent slopes	4.06	4.8%	Ille	IVe	61	4	69	83	25	39
7231	Judson silt loam, 2 to 6 percent slopes	2.18	2.6%	Ile	Ille	81	5	124	115	50	44
<b>Weighted Average</b>						<b>29.7</b>	<b>0.8</b>	<b>15</b>	<b>15.4</b>	<b>6.3</b>	<b>6.3</b>

\*c: Using Capabilities Class Dominant Condition Aggregation Method

Soils data provided by USDA and NRCS.