

Soils Map

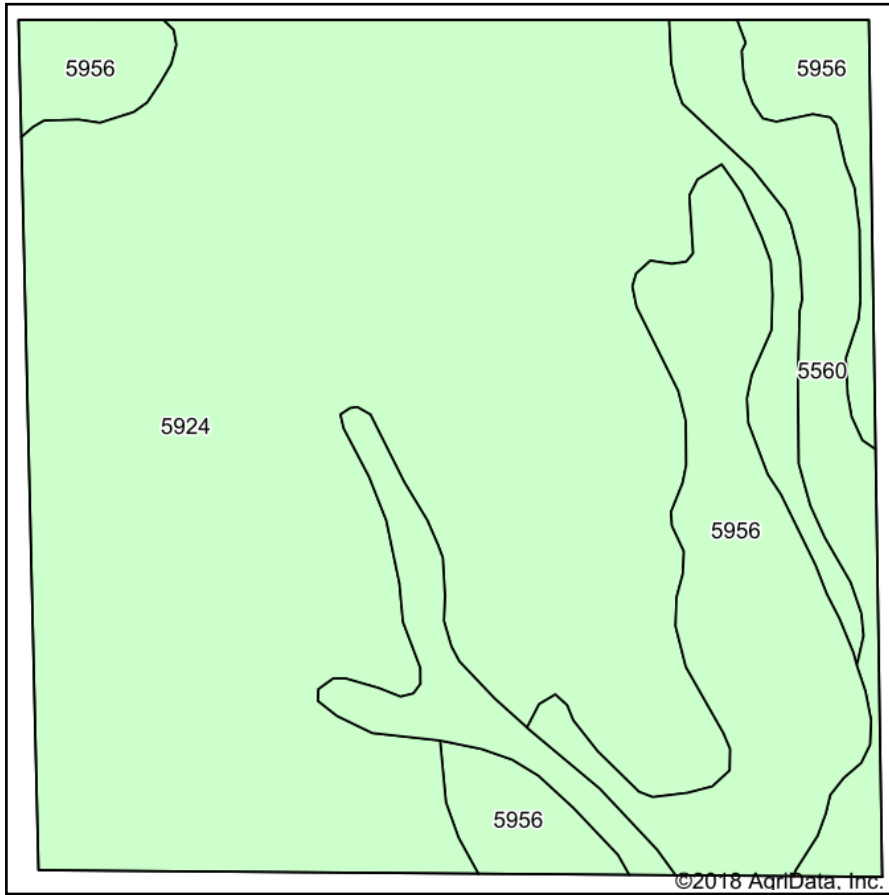

Soils data provided by USDA and NRCS.

©2018 AgriData, Inc.

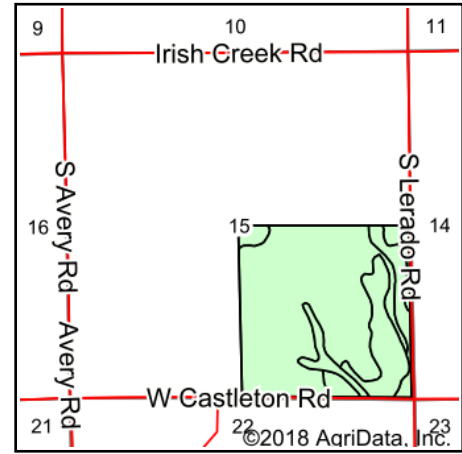

State: **Kansas**
 County: **Reno**
 Location: **15-25S-9W**
 Township: **Langdon**
 Acres: **156.46**
 Date: **1/5/2019**

 **The Pinnacle Agency**
 FARM MANAGEMENT-REAL ESTATE

Maps Provided By:

 CUSTOMIZED ONLINE MAPPING
 © AgriData, Inc. 2018 www.AgrIDataInc.com



Area Symbol: KS155, Soil Area Version: 15

Code	Soil Description	Acres	Percent of field	Non-Irr Class *c	Irr Class *c	*n NCCPI Soybeans
5924	Ost-Clark loams, 1 to 3 percent slopes	110.69	70.7%	Ile	Ile	69
5956	Shellabarger sandy loam, 1 to 3 percent slopes	29.73	19.0%	Ile	Ile	51
5560	Kanza-Ninnescah sandy loams, frequently flooded	16.04	10.3%	Vw		29
Weighted Average						*n 61.5

*n: The aggregation method is "Weighted Average using major components"

*c: Using Capabilities Class Dominant Condition Aggregation Method

Soils data provided by USDA and NRCS.