

Soil Map

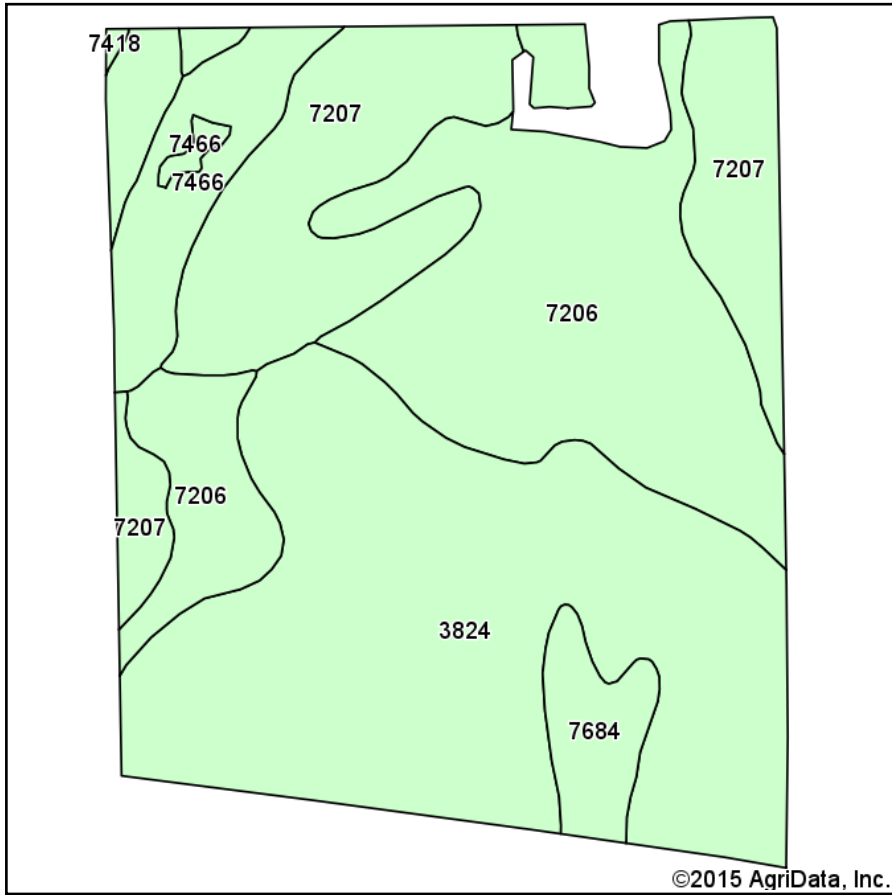

Soils data provided by USDA and NRCS.

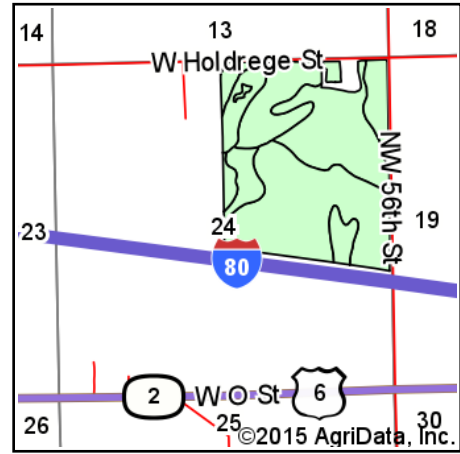

State: **Nebraska**
 County: **Lancaster**
 Location: **24-10N-5E**
 Township: **Middle Creek**
 Acres: **186.68**
 Date: **11/8/2015**

The Pinnacle Agency
 FARM MANAGEMENT-REAL ESTATE

Maps Provided By:



Area Symbol: NE109, Soil Area Version: 19

Code	Soil Description	Acres	Percent of field	Non-Irr Class *c	Irr Class *c	SRPG	Alfalfa hay	Alfalfa hay Irrigated	Bromegrass alfalfa	Bromegrass alfalfa Irrigated	Corn	Corn Irrigated	Grain sorghum	Grain sorghum Irrigated	Soybeans	Soybeans Irrigated
3824	Crete silt loam, 0 to 1 percent slopes	75.13	40.2%	Ils	Ils	73										
7206	Aksarben silty clay loam, 2 to 6 percent slopes	56.24	30.1%	Ile	IIle	72	4									
7207	Aksarben silty clay loam, 6 to 11 percent slopes	37.90	20.3%	IIle	IVe	68	4									
7466	Otoe silty clay, 6 to 11 percent slopes, eroded	10.93	5.9%	IVe	IVe	66	4	6			83	133	83	118	33	
7684	Wymore silty clay loam, 3 to 6 percent slopes, eroded	6.28	3.4%	IIle	IVe	70										
7418	Morrill clay loam, 6 to 11 percent slopes	0.20	0.1%	IIle	IVe	72	3	5	4	10	72	100	75	95	28	
Weighted Average						71.2	2.3	0.4	*-	*-	4.9	7.9	4.9	7	2	

Area Symbol: NE109, Soil Area Version: 19

*c: Using Capabilities Class Dominant Condition Aggregation Method

Soils data provided by USDA and NRCS.