

Soils Map

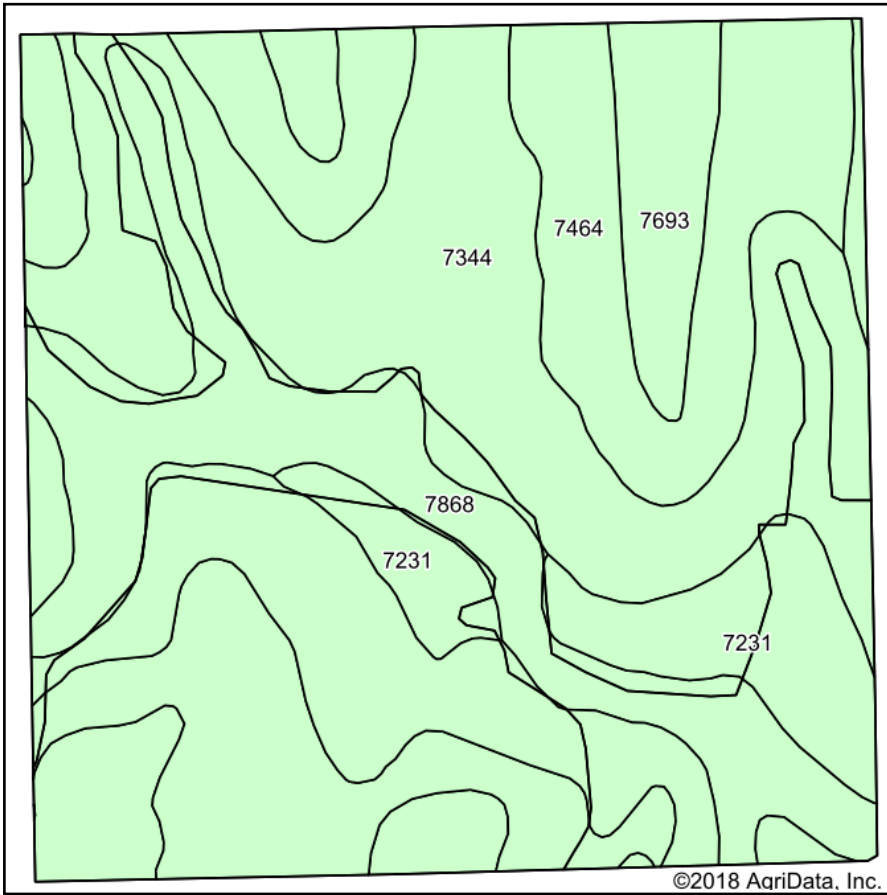

Soils data provided by USDA and NRCS.

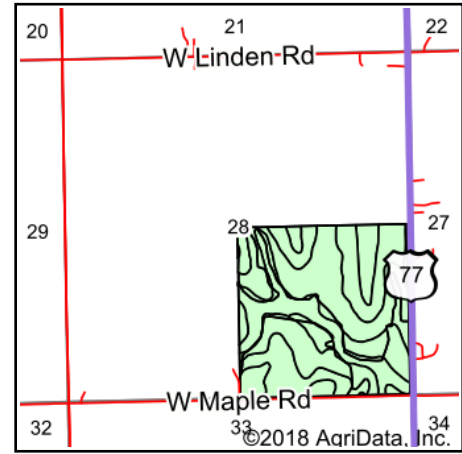

State: **Nebraska**
 County: **Gage**
 Location: **28-3N-6E**
 Township: **Riverside**
 Acres: **157.47**
 Date: **2/8/2018**

 **The Pinnacle Agency**
 FARM MANAGEMENT-REAL ESTATE

Maps Provided By:

 © Agridata, Inc. 2018 www.AgridataInc.com



Area Symbol: NE067, Soil Area Version: 20

Code	Soil Description	Acres	Percent of field	Non-Irr Class *c	Irr Class *c	SRPG	Alfalfa hay	Alfalfa hay Irrigated	Corn	Corn Irrigated	Grain sorghum	Grain sorghum Irrigated	Soybeans	Soybeans Irrigated	Winter wheat	Bromegrass alfalfa	Bro alfalfa
7344	Malmo, eroded-Pawnee complex, 6 to 11 percent slopes	60.74	38.6%	IVe		52											
7464	Otoe silty clay loam, 6 to 11 percent slopes, eroded	43.61	27.7%	IVe	IVe	66	4	6	82	133	82	117	33	47	40		
7868	Nodaway silt loam, channeled, occasionally flooded	24.10	15.3%	VIw		74	1	1	13	18	13	15	5	6	5		1
7693	Wymore silty clay loam, 2 to 6 percent slopes	16.39	10.4%	IIle	IIle	69											
7231	Judson silt loam, 2 to 6 percent slopes	12.63	8.0%	Ile	IIle	80	5	7	104	149	86	120	40	51	44		1
Weighted Average						63.3	1.7	2.4	33	51.5	31.6	44.3	13.1	18	15.4		0.2

*c: Using Capabilities Class Dominant Condition Aggregation Method

Soils data provided by USDA and NRCS.